



General notes

All setting out must be checked on site

All levels must be checked on site and refer to

Ordinance Datum Newlyn unless alternative Datum given

All fixings and weatherings must be checked on site

All dimensions must be checked on site

This drawing must not be scaled

This drawing must be read in conjunction with all other relevant drawings, specification clauses and current design risk register

This drawing must not be used for land transfer purposes

Calculated areas in accordance with Assael Architecture's Definition of Areas for Schedule of Areas

This drawing must not be used on site unless issued for construction

Subject to survey, consultation and approval from all statutory Authorities

Revision Status:
P= Preliminary
C= Contract

© 2017 Assael Architecture Limited

Assael Architecture Limited has prepared this document in accordance with the instructions of the Client under the agreed Terms of Appointment. This document is for the sole and specific use of the Client and Assael Architecture shall not be responsible for any use of its contents for any purpose other than that for which it was prepared and provided. Should the Client require to pass electronic copies of the document to other parties, this should be for co-ordination purposes only, the whole of the file should be so copied, but no professional liability or warranty shall be extended to other parties by Assael Architecture in this connection without the explicit written agreement thereto by Assael Architecture Limited.

Drawing notes

Electronic file reference

A2874 Eynsham Drive Plans Working

Status R:	Revision	Date	DRN	CHK	CDM
20	Planning Addendum	19/09/18	CS	ES	

Application boundary

Purpose of information

The purpose of the information on this drawing is for:

Planning	<input type="checkbox"/>
Information	<input checked="" type="checkbox"/>
Comment	<input type="checkbox"/>
Client approval	<input type="checkbox"/>
Construction	<input type="checkbox"/>

All information on this drawing is not for construction unless it is marked for construction.

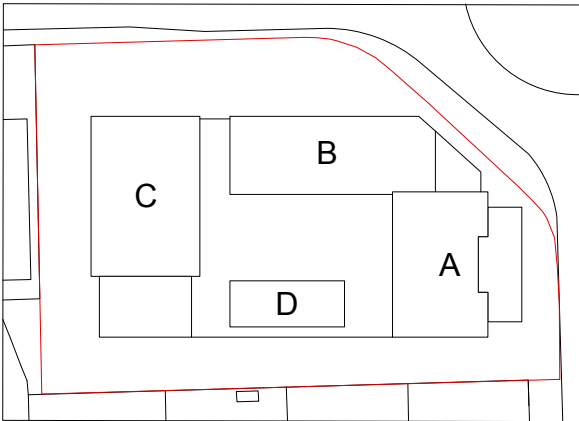

Client

Abbey Wood Property Ltd

Project title

Eynsham Drive Abbey Wood

Drawing title

Proposed Plan Thirteenth Floor

Scale @ A1 size	Date
1:200	Feb '17
Drawing N°	Status & Revision
A2874 213	R20

Assael